

ABACOA - CENTRAL BOULEVARD PLAT

153

A Portion of Sections 13 and 14, Township 41 South, Range 42 East
Town of Jupiter, Palm Beach County, Florida

This instrument prepared by James E. Park, P.S.M.
Williams, Hatfield & Stoner, Inc. - Engineers Surveyors Planners Environmental Scientists
1901 South Congress Avenue, Suite 150, Boynton Beach, Florida 33426

MARCH 1999

Sheet 2 of 6

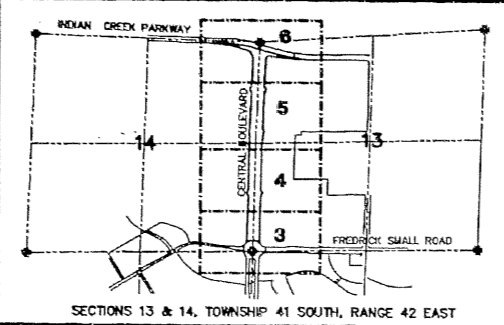

LOCATION MAP

STATE PLANE COORDINATES

| NO. | NORTHING | EASTING |
|-----|---------------|---------------|
| 1 | N 933087.8020 | E 945654.1213 |
| 2 | N 933152.5023 | E 945679.5773 |
| 3 | N 934251.5916 | E 945701.3432 |
| 4 | N 934272.3825 | E 945681.7436 |
| 5 | N 934347.3704 | E 945683.2281 |
| 6 | N 934358.5318 | E 945694.8401 |
| 7 | N 934508.3125 | E 945706.4183 |
| 8 | N 935516.4381 | E 945726.3760 |
| 9 | N 935733.8358 | E 945734.6559 |
| 10 | N 935754.5777 | E 945715.4362 |
| 11 | N 935829.5278 | E 945718.2911 |
| 12 | N 935830.8509 | E 945728.5397 |
| 13 | N 935997.2161 | E 945744.8879 |
| 14 | N 936751.8525 | E 945773.4176 |
| 15 | N 936784.5484 | E 945742.6569 |
| 16 | N 936848.5131 | E 945745.0934 |
| 17 | N 936863.8047 | E 945763.7572 |
| 18 | N 937070.8475 | E 945785.2855 |
| 19 | N 937553.5488 | E 945805.5798 |
| 20 | N 937612.9635 | E 945799.4211 |
| 21 | N 937646.1576 | E 945775.1476 |
| 22 | N 937660.1229 | E 945759.6456 |
| 23 | N 937744.3996 | E 945656.0075 |
| 24 | N 937809.5696 | E 945500.0416 |
| 25 | N 937925.0064 | E 944851.4345 |
| 26 | N 937914.2973 | E 945194.5107 |
| 27 | N 937878.6508 | E 945609.3226 |
| 28 | N 937652.5012 | E 946393.5519 |
| 29 | N 937529.4520 | E 947258.9459 |
| 30 | N 937579.3586 | E 947248.2714 |
| 31 | N 937574.0111 | E 946506.3692 |
| 32 | N 937626.4150 | E 946183.2276 |
| 33 | N 937608.8055 | E 946151.0031 |
| 34 | N 937582.8445 | E 946126.4864 |
| 35 | N 937535.7853 | E 946103.5158 |
| 36 | N 936878.8050 | E 946078.4917 |
| 37 | N 936845.6081 | E 945109.2499 |
| 38 | N 936770.6602 | E 946106.5951 |
| 39 | N 936752.0056 | E 946086.2823 |
| 40 | N 936561.7830 | E 946066.4147 |
| 41 | N 935860.6322 | E 946039.7080 |
| 42 | N 935827.1092 | E 946070.7733 |
| 43 | N 935752.1815 | E 946067.9184 |
| 44 | N 935733.0818 | E 946047.3266 |
| 45 | N 935561.2037 | E 946026.1358 |
| 46 | N 934372.8239 | E 946003.7974 |
| 47 | N 934340.4052 | E 946024.9574 |
| 48 | N 934276.4154 | E 946033.8906 |
| 49 | N 934253.5547 | E 946011.9868 |
| 50 | N 934087.1085 | E 945998.1419 |
| 51 | N 933164.9753 | E 945978.8067 |
| 52 | N 933072.1771 | E 946009.7281 |

AREA TABULATION

| FOR THE USE OF NORTHERN PALM BEACH COUNTY IMPROVEMENT DISTRICT | | | |
|--|-------------|-------------------------|---------------|
| TRACT DESIGNATION | ACREAGE | LAND USE CLASSIFICATION | GROSS ACREAGE |
| TRACT A | 34.83 ACRES | ERZ | 34.83 ACRES |

SURVEYOR'S CERTIFICATE

THIS IS TO CERTIFY THAT THE PLAT SHOWN HEREON IS A TRUE AND CORRECT REPRESENTATION OF A SURVEY MADE UNDER MY RESPONSIBLE SUPERVISION AND BELIEF, THAT PERMANENT REFERENCE MONUMENTS (P.R.M.'s) AND MONUMENTS ACCORDING TO SEC. 177.09(1), F.S., HAVE BEEN PLACED AS REQUIRED BY LAW AND, FURTHER, THAT THE SURVEY DATA COMPLIES WITH ALL THE REQUIREMENTS OF CHAPTER 177, FLORIDA STATUTES, AS AMENDED AND THE ORDINANCES OF THE TOWN OF JUPITER, FLORIDA.

James E. Park
JAMES E. PARK, P.S.M.
LICENSE NO. 3915
STATE OF FLORIDA

NOTES

- ALL BEARINGS SHOWN HEREON ARE PLAT UNLESS OTHERWISE NOTED. STATE PLANE COORDINATES ARE RELATIVE TO A GRID AZIMUTH (MAD 83/90 ADJUSTMENT) BASED ON THE PALM BEACH COUNTY RESURVEY OF THE EAST LINE OF THE SOUTHEAST ONE-QUARTER OF SECTION 14, TOWNSHIP 41 SOUTH, RANGE 42 EAST, SAID EAST LINE HAVING A BEARING OF N01°00'07"E.
 - COORDINATES SHOWN ARE GRID
DATUM = NAD 83 1990 ADJUSTMENT
ZONE = FLORIDA EAST
LINEAR UNIT = U.S. SURVEY FOOT
COORDINATE SYSTEM = 1983 STATE PLANE TRANSVERSE MERCATOR PROJECTION
SCALE FACTOR = 1.00002118
GROUND DISTANCE X SCALE FACTOR = GRID DISTANCE
N01°00'07"E (PLAT BEARING) = 0°00'00" COUNTERCLOCKWISE BEARING ROTATION (PLAT TO GRID)
EAST LINE OF SECTION 14, TOWNSHIP 41 SOUTH, RANGE 42 EAST PER PALM BEACH COUNTY RESURVEY
 - THIS PLAT, AS RECORDED IN ITS GRAPHIC FORM, IS THE OFFICIAL DEPICTION OF THE SURVEYED LANDS DESCRIBED HEREIN AND WILL IN NO CIRCUMSTANCES BE SUPPLANTED IN AUTHORITY BY ANY OTHER GRAPHIC OR DIGITAL FORM OF THE PLAT. THERE MAY BE ADDITIONAL RESTRICTIONS THAT ARE NOT RECORDED ON THIS PLAT THAT MAY BE FOUND IN THE PUBLIC RECORDS OF THIS COUNTY.
 - THE 100' VIEWED AND POSTED RIGHT-OF-WAY LYING WITHIN THE PLAT BOUNDARY SHOWN HEREIN WAS RELEASED BY PALM BEACH COUNTY PER OFFICIAL RECORDS BOOK 11297, PAGES 210-213.
- ⊙ - DENOTES PERMANENT REFERENCE MONUMENT (P.R.M. NO. 3915)
 UE - DENOTES UTILITY EASEMENT
 ORB - DENOTES OFFICIAL RECORDS BOOK, PALM BEACH COUNTY RECORDS
 LAE - DENOTES LIMITED ACCESS EASEMENT
 R/W - DENOTES RIGHT-OF-WAY
 1/2 - DENOTES INGRESS/EGRESS EASEMENT